

Technical data sheet for

Halton VH32 VENTLESS CONDENSING HOOD

Ventless Condensing Hoods for TURBOFAN E32D E32T Convection Ovens

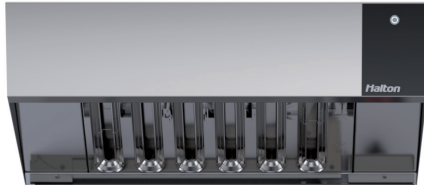

VH32

Unit shall be a Halton Ventless Condensing Hood, UL listed and UL EPH classified. The unit shall have all stainless steel construction, include 3 stage filtration and incorporate a condensing heat exchanger. Unit will feature an automatic 2 speed extraction fan with interlocked oven operation, Unit shall be 110-120V and fitted with a NEMA 5-15P cordset. Unit shall be provided with VHIK32 Installation Kit for connection and fitment to Moffat Turbofan Convection Oven model E32D4, E32D5, E32T4, E32T5.

VHIK32 Installation Kit

Installation Kit shall be provided with VH32 Ventless Condensing Hood.

Installation kit shall include:

Wire Harness for Oven Interlock connection to Oven Controls.

Four 4" (100mm) oven feet and condensate collection pan and housing for self-contained condensate collection.

Oven Rear shroud for protection of Interlock control harness and condensate drain tube.

Oven to stand rear securing plate when oven is fitted on a Moffat Turbofan SK32 Stand.

STANDARD FEATURES

- Removes need for installation Canopy or Ducted Oven Hood
- Complies with EPA202 Test Method for less than <5mg/m³ grease laden effluent limits when fitted to Turbofan Convection Oven models E32D, E32T
- UL197, NSF2/ANSI 2 certified
- 3 STAGE FILTERS
 - Grease baffle filter - removable for cleaning
 - Mesh particle filter - removable for cleaning
 - Charcoal odour filter - replaceable
- CONDENSING HEAT EXCHANGER
 - Oven vent condensing
 - Reduces heat emissions
- SELF CONTAINED CONDENSATE COLLECTION
 - Condensate drains to collection pan below oven (No connection to waste drain required)
- REMOTE CONDENSATE DRAIN OPTION
 - Condensate drain tube can be taken to a permanent waste drain (no manual emptying of condensate collection required)
- OVEN INTERLOCKED OPERATION
 - Oven will not operate if Hood not turned on.
 - Oven control alarm notification if Hood not operating.
 - Illuminated power switch on Hood.
- AUTOMATIC 2 SPEED EXTRACTION FAN
 - Low fan speed during idle or cooking/baking process – reduced noise/energy.
 - Automatic high fan speed 10 seconds before end of cook/bake timer or program.
 - Automatic high speed fan extraction when oven door open.
- 110-120V plug-in 15A NEMA 5-15P cordset fitted

VHIK32 INSTALLATION KIT

- Supplied Standard with VH32 Hoods
 - Requires mechanical and electrical field assembly and connection of VH32 Hood to E32D/E32T Ovens

ACCESSORIES – OPTIONAL

- # H11715 Replacement Charcoal Filter

Halton VH32 Ventless Condensing Hood

CONSTRUCTION

304 Stainless steel
Welded casing
Service panels top and rear

CONTROLS

Illuminated Power switch.
Oven interlocked control

CLEANING

All Stainless steel finish
Removable Grease baffle filter
Removable Mesh filter
Replaceable Charcoal Filter

SPECIFICATIONS

Electrical Requirements
110-120V, 60hz, 1-phase, 1.0A
NEMA 5-15P 6ft cordset fitted

Water Requirements

No water connection required

Drain Requirements – Optional.

Hood water condensate can be taken to a water waste drain if desired.

A 6ft / 1800mm long 3/8"OD drain hose is supplied with hood.

External Dimensions

Width: 29 1/4" / 742mm
Height: 14 1/2" / 368mm
Depth: 40" / 1017mm
Allow 3" / 76mm rear clearance

Nett Weight:

103 lbs / 46.5 kg

Packing Data

125lbs / 57 kg
19ft3 / 0.7 m3
Width: 31 1/2" / 800mm
Height: 21 1/2" / 545mm
Depth: 44" / 1120mm



www.moffatusa.com
www.turbofanoven.com

U.S.A.

Moffat Inc
3760 Industrial Drive, Suite B
Winston-Salem
NC 27105-2637
Ph 336-661 0257
Ph Toll Free 1-800-551 8795
Fax 336-661 9546
Email sales@moffat.com
www.moffatusa.com

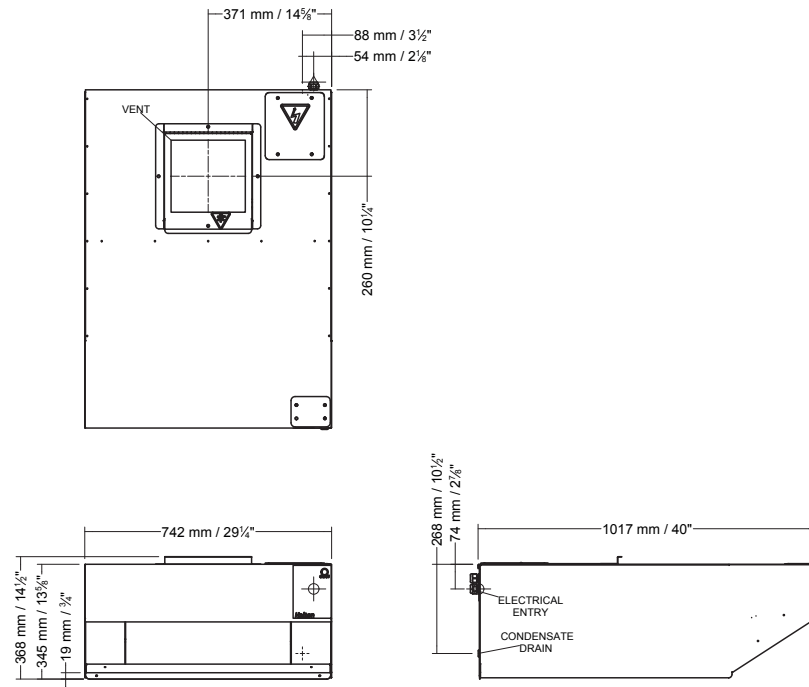

Halton

VH Series Ventless Condensing Hoods are manufactured by Halton Company, USA, exclusively for Moffat Turbofan Convection Ovens.



In line with policy to continually develop and improve its products, Moffat Limited reserves the right to change specifications and design without notice.

Moffat Limited
45 Illinois Drive, Izone Business Hub
Rolleston 7675, New Zealand

© Copyright Moffat Ltd
US.TFN.S.2101

