



Equipment for the Foodservice Industry

value + quality + service

Back Bar Solid Door Coolers (Stainless Steel)

CBBSDR2-60CC



CBBSDR2-60CC Features

Features

- Exterior front, side and counter covered in stainless steel
- Counter tops and interiors are made with Type 304 stainless steel
- Recessed handles
- Swing doors equipped with locks for security
- Self-closing doors equipped to stay open when past 90 degrees
- Adjustable/removable plastic coated shelves
- Refrigeration system holds 33°F to 41°F(-0.5°C

to 5°C) for optimum food preservation

- R290 refrigerantFoamed-in polyurethane cell insulation
- Removable installation board makes it easy to access condenser coil for cleaning and service

Warranty

- Two year parts and labour; Five years on compressor. *For full warranty details visit <https://www.efifoodequip.com/warranty-info.php>*



CBBSDR2-60CC Specifications

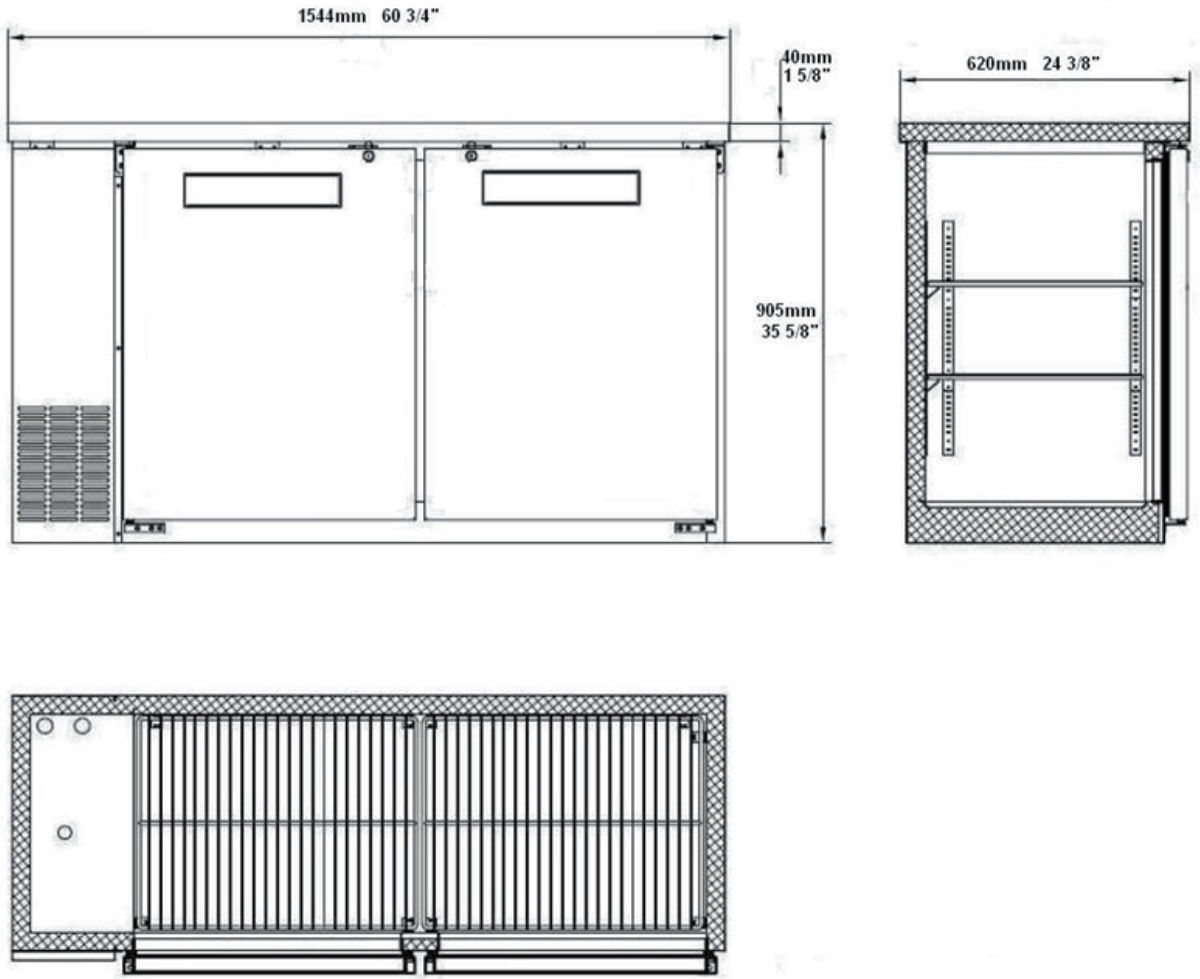

Model	Doors	Dimension (mm / inch)			HP	Voltage	Amps	Capacity (L / Cu Ft.)	Net Weight (KG / LBS)	NEMA Config.
		L	D	H						
CBBSDR2-60CC	2	1544	620	905	1/5	115/60/1	2.88	447.4	172.3	5-15P 
		60.8	24.4	35.6				15.8	380	

Specifications subject to change without notice.